

**Accessoiers**

**Adapter 2.50 mm to 1.25 mm**

Part Number: 1400000070

**Applications:** - Adapts patented **2.50 mm FIBERPOINT®** connection to a **1.25 mm** connection. Consequently you can check most of the popular fiber connector types with just one fiber fault locator.



FIBERPOINT® 250 with Adapter



FIBERPOINT® 250MD with Adapter



Ferrule 1.25 mm

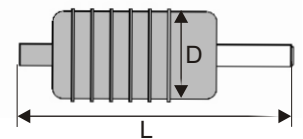

D (mm)	8.5
L (mm)	26

Parameter	Specification
Side of the FIBERPOINT®	2.50 mm SM-ferrule
Side of the fiber	1.25 mm connection for LC, MU, F3000 etc.
Attenuation	< 1.0 dB
Weight	10 g

**Included in delivery:** - Dust cap on both sides  
- Plastic foil bag packaging

Compliant with RoHS-requirements (2002/95/EG vom 27.01.2003)  
Note: The above product specifications are subject to change without notice.