

Fiber Optic Fault Locator

FIBERPOINT® ET

Part Number: 1400000079Q / 79E



Ferrule 2.5 mm

- Applications:**
- The compact design of the visual fault locator is very suitable for **daily use** in all fiber optic applications e.g. **in the field, in industrial environment as well as in laboratories.**
 - Check **singlemode/multimode** optical fibers and other fiber optic components on faults.
 - **Patching** of fibers

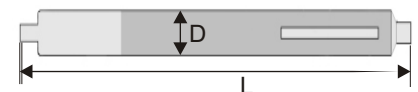

D (mm)	12.1
L (mm)	151

Parameter	Min.	Typ.	Max.
Wavelength	650 nm	655 nm	660 nm
Operation temperature	- 10 °C		45 °C
Storage temperature	- 40 °C		70 °C
Fiber coupled power	(Singlemode fiber 9/125 μm)	200 μW	350 μW
	(Multimode fiber 50/125 μm)	200 μW	600 μW
Optical output power			1 mW
Operation current		35 mA	
Retention force for ferrule		1-2 N	
Weight incl. batteries		70 g	
Operation time - one battery pack ¹ (Pulsed mode)		40 hours	
Battery type		AAA	
Operation mode	Continuous CW; Pulsed mode: Freq.: 2-3 Hz		
Laser protection class	2		
Suitable ferrule 2.5 mm	DIN, E2000, FC, SC, ST		

- Included in delivery:**
- Dust cap
 - One battery pack
 - Instruction manual

Accessories (not included): - Adapters please see page 7/8 this brochure

- Order Number:**
- 1400000079Q: Individually packed in Quadrosave
 - 1400000079E: Individually packed in durable FIBERPOINT® plastic box

- Feature:**
- Private labelling is available
 - Minimum order quantity applies
 - For resellers only

Notes: Do not use rechargeable batteries.

Compliant with RoHS-requirements (2002/95/EG vom 27.01.2003)

The above product specifications are subject to change without notice.

¹⁾ Battery: VARTA Industrial Alkaline No. 4003; 1.5 V; AAA; LR03 Micro; AM4; MN2400